

LINED VALVES



VALVE SOLUTIONS for Corrosive Applications



UNPPolyvalves

Manufacturer of PFA/FEP/PTFE Lined & Plastic Valves,
Pipes & Pipe Fittings



VALVE SOLUTIONS for Corrosive Applications

About Us

UNP Polyvalves is manufacturing Corrosive application valves since 1988.

UNP started with all plastic valves with limited size options, today has a complete range of corrosive application valves in both options of Solid Plastic valves and Lined valves. UNP now has in its range Ball, Plug, Butterfly, Diaphragm valves, Non-return valves, Strainers, Sampling valves, Pipes and Pipe Fittings. This completes range of complete piping solution in corrosive applications.

UNP has most modern facility situated at Por with latest moulding technology and highest moulding capacity to manufacture lined valves as large as 24" with Injection moulding machines of largest capacity in the country.

Envisioned for quality and reliability, UNP Polyvalves aims for highest level of Customer satisfaction through its solutions with the commitment for excellence in all spheres of business.

UNP Polyvalves possesses live skill sets headed by highly knowledgeable, technically

experienced entrepreneurs. These experts lead and guide their team with a great vision to achieve high quality standards to make products for its high performance and unmatched quality.

UNP Polyvalves, over all these years has been dealing with almost all chemical process industries in Chlor Alkali, Chemical, Pharmaceutical, Mining, Refineries etc., in India and exporting to 35+ countries in the world including market such as USA, Europe, Latin America, Africa, Russia, South East Asia, Australia etc. . .

Achievements

UNP Polyvalves through its technical expertise and involvement in knowing Physical process parameters could help resolving corrosion problems related to valves and piping system in Industries such as Chlor Alkali, CRM in Steel Industries, Chemical injection skids for Oil and Gas and many more chemical plant across the world. UNP today has approvals from leading consultants such as UHDE, Jacobs Engineering, Mott McDonald, Toyo Engineering, Fluor Daniel, TUV, EIL etc., and have worked for their prestigious projects.

LINED GLOBE VALVE FLANGED ENDS



UNPPolyvalves

PART LIST

PART NO.	DESCRIPTION	MATERIAL OF CONSTRUCTION	QTY.
1	Body	ASTM A 216 GR.WCB + PFA LINED	1
2	Bonnet / Yoke	ASTM A 216 GR.WCB + PFA LINED	1
3	Plug With Integral Stem	SS 304 + PFA LINED	1
4	Spindle	SS 304	1
5	Gland Cover	ASTM A 216 GR. WCB	1
6	Chevron Packing	PTFE	4
7	Saddle Nuts	SS 304	2
8	Saddle	ASTM A 216 GR. WCB	1
9	Stem Sleeve	SS 304	1
10	Saddle Allen Bolts	HT STEEL GR. 10.9	2
11	Saddle Bolt Washers	STEEL	2
12	Grub Screws For Sleeve	HT	2
13	Body Bolts	ASTM A 193 GR. B7	4-6
14	Body Bolt Washers	STEEL	4-6
15	Stem Lock Nuts	SS 304	2
16	Hand Wheel	CARBON STEEL	1
17	Handwheel Washer	STEEL	1
18	Handwheel Nut	SS 304	1

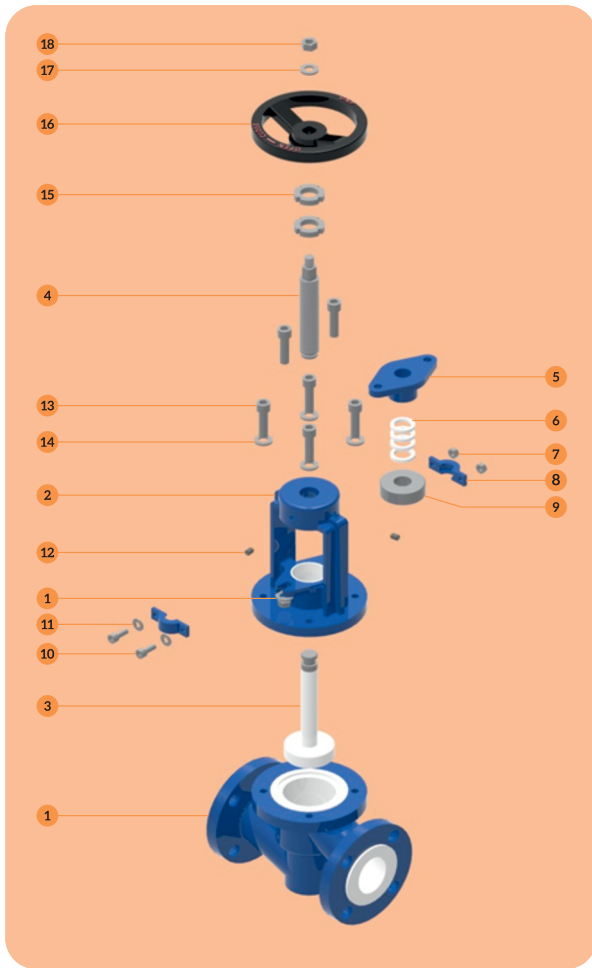

PRODUCT DESIGN AND TESTS PERFORMED

DESIGN PARAMETERS	STANDARD
Design Standard	API 600 / BS 18 73
Shell Design	ANSI B 16.34
Face To Face Dimensions	EN 558- SERIES 1
Flange Connection Rating	ANSI B 16.5 150# / DIN PN 10
Testing Standard	BS EN 12266-1
Connection	FLANGED, RF
TESTS PERFORMED	EN 12266-1
Sizes	0.5"-4"
High Pressure Shell Test Hydro	225 PSI
High Pressure Seat Test Hydro	165 PSI
Low Pressure Seat Test Pneumatic	75 PSI
SPARK TEST	KVDC
Testing Done At	20 KVDC
MATERIAL	OPTIONS AVAILABLE
Castings	ASTM A 216 GR. WCB, ASTM A 351 GR. CF8 / CF8M, HASTELLOY C 276 / INCONEL
Lining Materials	PFA/PEP/ETFE/PVDF/PPH

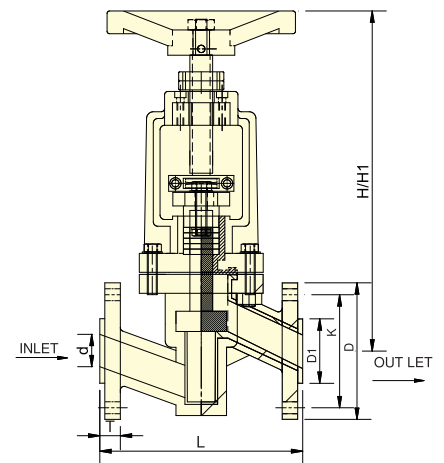

DIMENSIONS

Size	L ±0.12		d ±0.04		D1 ±0.08		D ±0.08		K ±0.08		T ±0.05		H1 ±0.10		n	Ø	
	INCH	MM	INCH	MM	INCH	MM	INCH	MM	INCH	MM	INCH	MM	INCH	MM		INCH	MM
0.5"	5.11	130	0.49	12.5	1.37	35	3.74	95	2.36	60	0.59	15	10.40	265	04	5/8	16
0.75"	5.90	150	0.74	19	1.69	43	4.13	105	2.75	70	0.59	15	10.40	265	04	5/8	16
1"	6.29	160	0.98	25	2.48	51	4.25	108	3.10	79	0.61	15.5	11.60	295	04	5/8	16
1.5"	7.87	200	1.49	38	2.87	73	5.07	129	3.85	98	0.82	21	14.30	365	04	5/8	16
2"	9.05	230	1.96	50	3.62	92	6.06	154	4.76	121	0.82	21	15.40	393	04	3/4	19
3"	12.20	310	2.95	75	5.00	127	7.48	190	6.00	152.5	0.98	25	18.30	465	04	3/4	19
4"	13.77	350	3.93	100	6.18	157	9.01	229	7.50	191	1.06	27	21.50	547	08	3/4	19

All Dimensions are in Inches & mm unless otherwise specified. PCD of the Valve can be provided in ANSI / DIN / JIS.
Tolerances are given in Inches.

GLOBE CONTROL VALVE FLANGED ENDS



PRODUCT DESIGN AND TESTS PERFORMED

DESIGN PARAMETERS	STANDARD	
Design Standard	API 600 / BS 18 73	
Shell Design	ANSI B 16.34	
Face To Face Dimensions	EN 558-SERIES 1	
Flange Connection Rating	ANSI B 16.5 150# / DIN PN 10	
Testing Standard	BS EN 12266-1	
Connection	FLANGED, RF	
TESTS PERFORMED	EN 12266-1	EN 12266-1
Sizes	0.5"-4"	5"-8"
High Pressure Shell Test Hydro	225 PSI	135 PSI
High Pressure Seat Test Hydro	165 PSI	105 PSI
Low Pressure Seat Test Pneumatic	75 PSI	75 PSI
SPARK TEST	KVDC	
Testing Done At	20 KVDC	
MATERIAL	OPTIONS AVAILABLE	
Castings	ASTM A 216 GR. WCB, ASTM A 351 GR. CF8 / CF8M, HASTELLOY C 276 / INCONEL	
Lining Materials	PFA/PEP/ETFE/PVDF/PPH	

PART LIST

PART NO.	DESCRIPTION	MATERIAL OF CONSTRUCTION	QTY.
1	Body	ASTM A 216 GR.WCB + PFA LINED	1
2	Bonnet	ASTM A 216 GR.WCB BOLTED	1
3	Bellow	PTFE	1
4	Stem	SS 316	1
5	Adaptor	CS + PFA + LINED	1
6	Fasteners	SS 304	-
7	Actuator	CI EPOXY PAINTED	1
8	Yoke	CI EPOXY PAINTED	1
9	Positioner	CUSTOMER REQUIREMENT	1
10	AFR	CUSTOMER REQUIREMENT	1
11	Tubing	SS 304	1

SECTIONAL VIEW

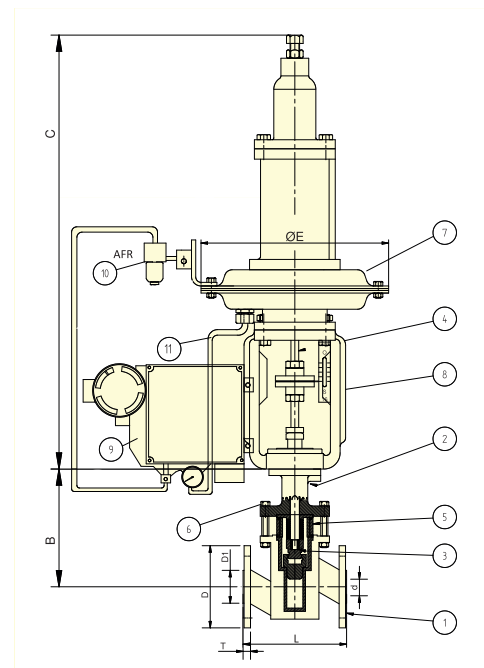

DIMENSIONS

Size	L ±0.11		d ±0.04		D1 ±0.04		D ±0.04		K ±0.062		T ±0.11/0.00		n	Ø		B ±0.00		C ±0.00		ØE	
	INCH	MM	INCH	MM	INCH	MM	INCH	MM	INCH	MM	INCH	MM		INCH	MM	INCH	MM	INCH	MM	INCH	MM
0.5"	5.11	130	0.49	12.5	1.37	35	3.74	95	2.36	60	0.59	15	04	5/8	16	6.50	165	26.3	670	11.4	290
0.75"	5.90	150	0.74	19	1.69	43	4.13	105	2.75	70	0.59	15	04	5/8	16	7.16	182	26.3	670	11.4	290
1"	6.2	160	0.98	25	2.00	51	4.25	108	3.11	79	0.49	12.5	04	5/8	16	7.16	182	26.3	670	11.4	290
1.5"	7.87	200	1.5	38	2.87	73	5.00	127	3.86	98	0.7	18	04	5/8	16	9.76	248	26.3	670	11.4	290
2"	9.0	230	1.97	50	3.62	92	5.98	152	4.76	121	0.7	18	04	3/4	19	10.1	258	26.3	670	11.4	290
3"	12.2	310	2.95	75	5.0	127	7.48	190	5.98	152	0.86	22	08	3/4	19	11.4	290	27.4	697	15.0	382
4"	13.7	350	3.7	100	6.18	157	9.01	229	7.52	191	0.94	24	08	3/4	19	13.0	331	27.4	697	15.0	382

All Dimensions are in Inches & mm unless otherwise specified. PCD of the Valve can be provided in ANSI / DIN / JIS.
Tolerances are given in Inches.